

THE BOLD LOOK OF **KOHLER**

INSTALLATION INSTRUCTIONS QUIET-CLOSE TOILET SEAT WITH QUICK RELEASE MECHANISM PARLIAMENT 16950A-0

BEFORE YOU BEGIN

Thank you for choosing the Bold Look of Kohler. Kohler craftsmanship offers you a rare combination of proven performance and graceful sophistication that will satisfy you for years to come. The quality and dependability of your Kohler toilet seat will surpass your highest expectations. We're very proud of our products here at Kohler and we know you will be too.

Please take a few minutes to study this manual. Pay special attention to the Care and Cleaning instructions. All information in this manual is based upon the latest product information available at the time of publication. At Kohler, we constantly strive to improve the quality of our products. We reserve the right to make changes in product characteristics, packaging or availability at any time without notice.

INSTALLATION

Install the Toilet Seat

Remove the existing toilet seat and mounting hardware.

Dispose of the old toilet seat and mounting hardware.

If necessary, clean the toilet surface.

Seat Toggle
1071559

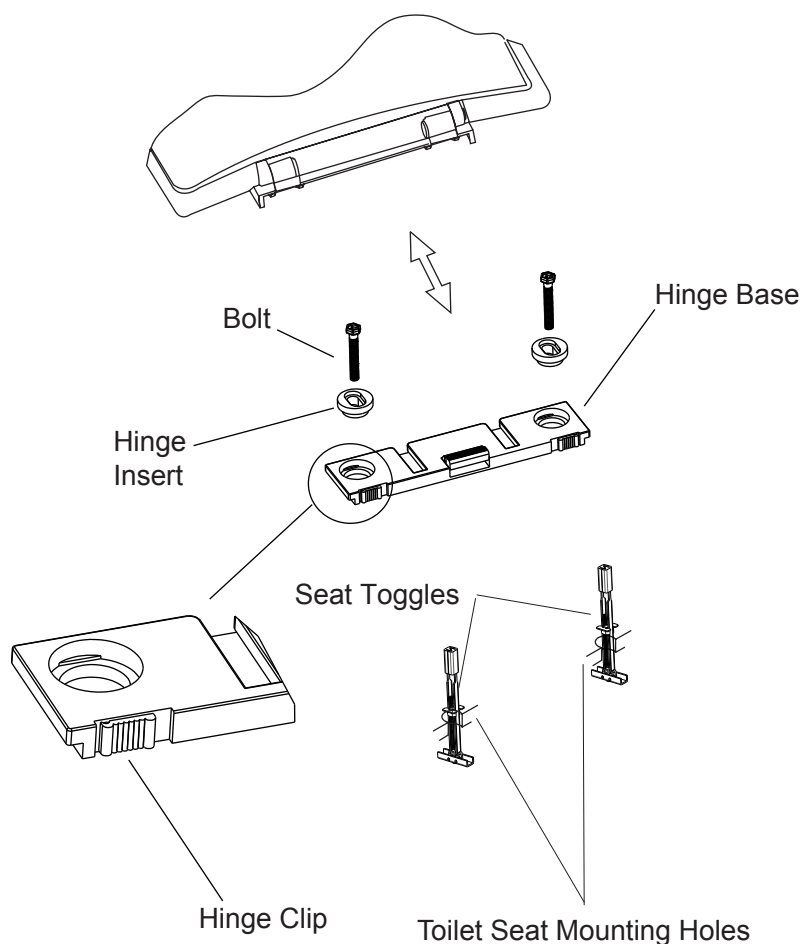
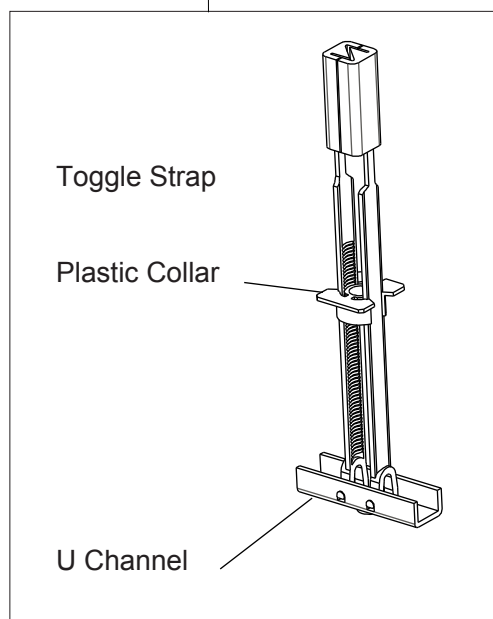

Seat Toggle Installation

Insert the toggle strap into the seat hinge hole on the pan

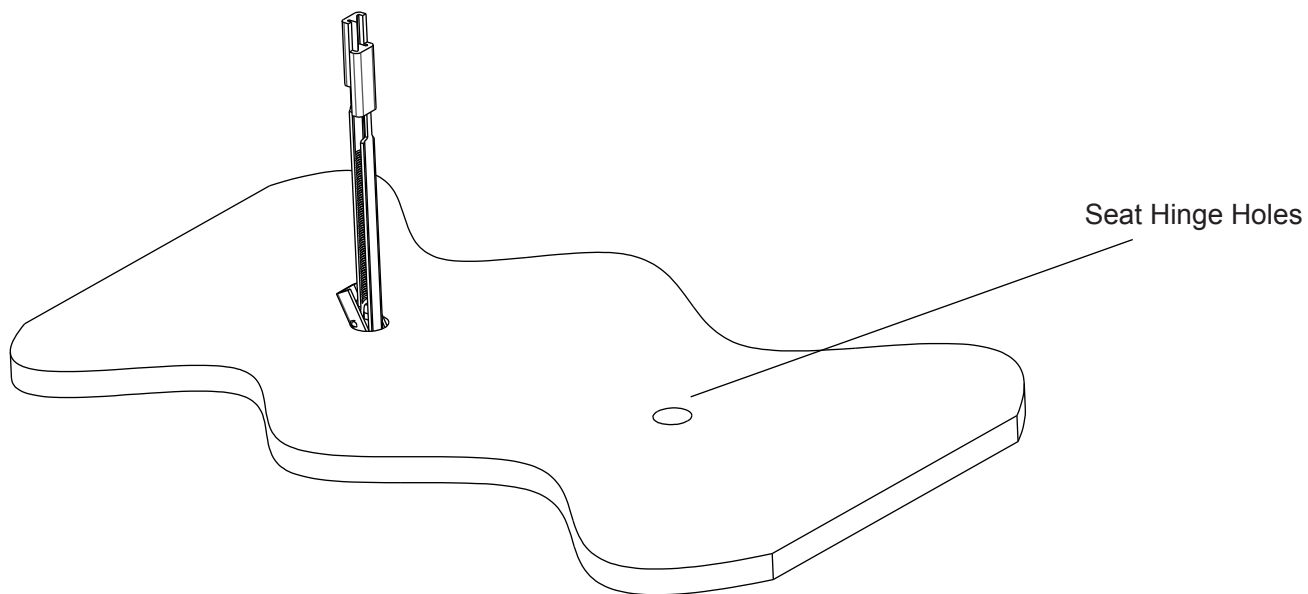

Hold the end of the straps and pull the toggle upwards.
Ensure the U Channel is flush with the underside of the pan.

With the other hand slide the plastic collar down onto the toilet.
Ensure the plastic collar is flush.

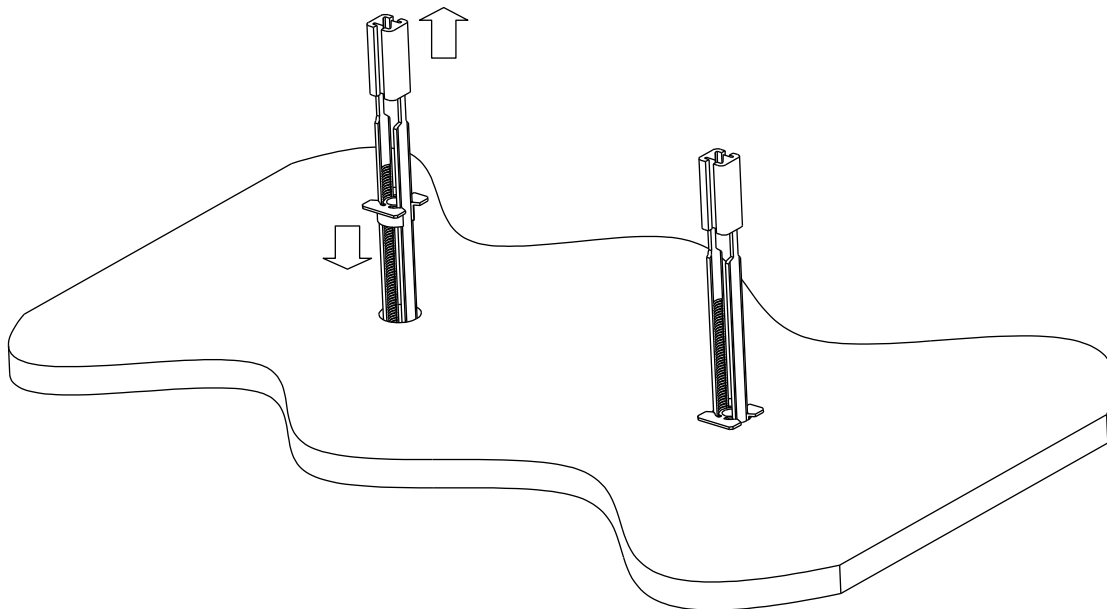

Snap the toggle strap off, by holding it at the plastic collar and moving it from side to side. Ensure the straps snaps off flush to the plastic collar.

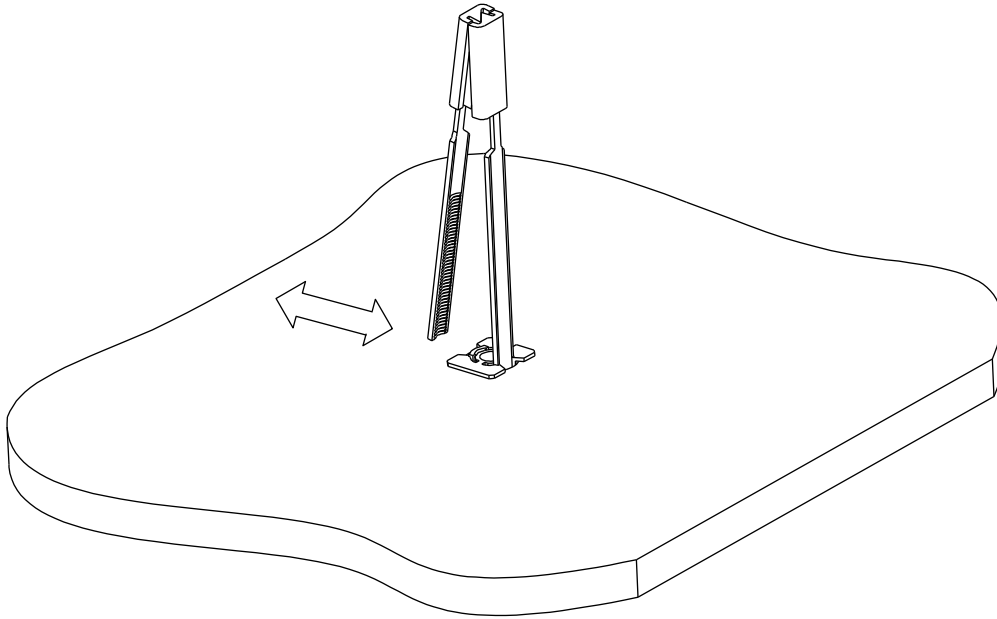

Align the seat fixing holes over the plastic collar and fix with the bolts provided.

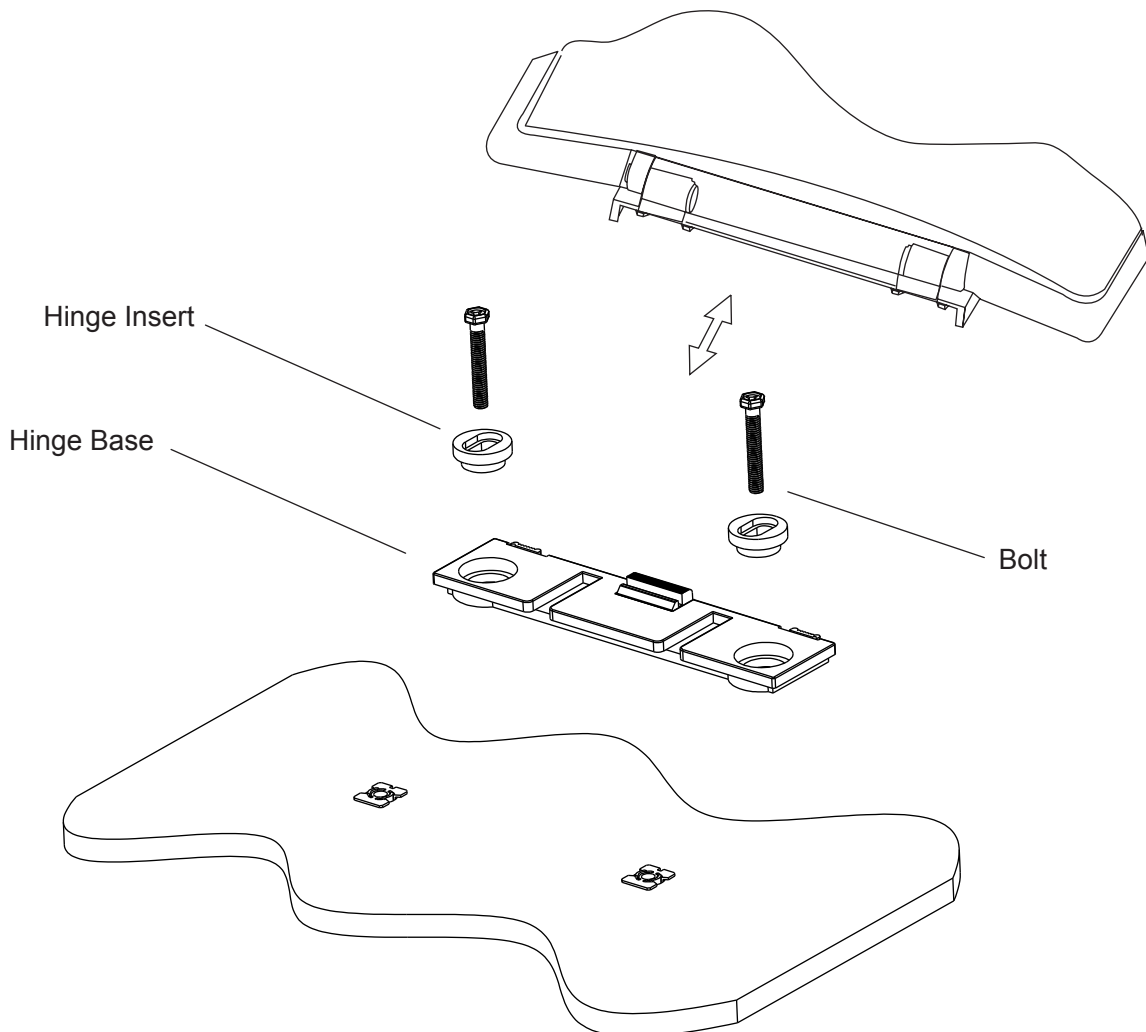

OPERATION

Your Kohler Toilet seat is designed to close slowly when the lid is released. To close simply push the lid forwards.

The toilet seat also has an easy to clean quick release hinge that allows the toilet seat to be quickly removed for complete cleaning.

Move the hinge clips towards the centre of the hinge base.

Depress the button located on the top of the hinge base.

Pull the toilet seat forward, leaving the hinge base in place.

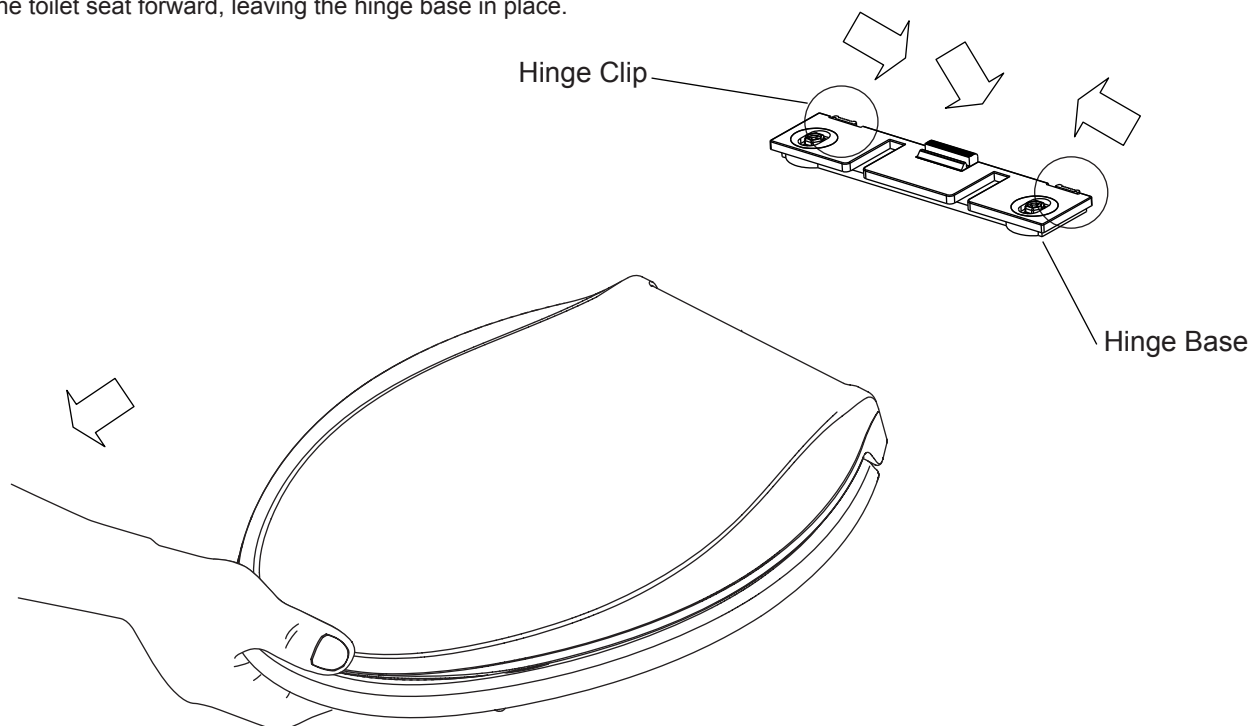

After cleaning, push the toilet seat back into place on the hinge base and push the hinge clips away from the centre of the hinge base.

IMPORTANT CONSUMER INFORMATION

Care and Cleaning

The toilet seat may be completely removed for a complete cleaning. Refer to the Operation Section.

Clean the surface of your toilet seat with mild soap and warm water. Wipe the entire surface completely dry with a clean, soft cloth.

Do not use strong abrasive cleaners, as they will scratch and dull the surface.

SPARE PARTS

1085373 - Hinge Base, Parliament Quiet Close Seat

1085374 - Bumper, Lid, Parliament Quiet Close Seat

1085375 - Bumper, Ring, Parliament Quiet Close Seat

CONTACT AND WARRANTY INFORMATION

For warranty information, please visit our website

Australia
www.au.kohler.com

New Zealand
www.kohler.co.nz

KOHLER

CALL US FOR HELP

NEW ZEALAND
KOHLER NZ LTD

Free Ph: 0800 564 537 (0800 KOHLER)
Free Fax: 0800 664 488
www.kohler.co.nz

AUSTRALIA
KOHLER CO.

Free Ph: 1300 658 277
Fax: 02 9618 1189
www.au.kohler.com